

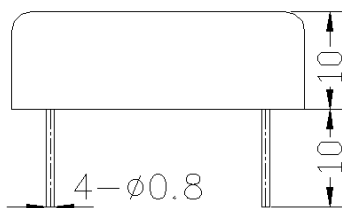

Specification: Crystal Filter 40.455MHz

Part Number: 40.455M40B50

| Item | Typical |
|---------------------------------------|-----------|
| Nominal Frequency (MHz) fo | 40.455 |
| Insertion Loss (dB) | ≤3.0 |
| Ripple within Pass band (dB) | ≤1.0 |
| Bandwidth at -3dB (kHz) | ±20 |
| Stop Band Rejection (dB), f0±40 kHz | ≥20 |
| Stop Band Rejection (dB), f0±60 kHz | ≥45 |
| I/O Impedance (Ω) | 50 |
| I/O VSWR | ≤1.8 |
| Operation Temperature (°C) | -40 ~ +80 |
| Storage Temperature (°C) | -45 ~ +85 |
| Package Size (mm) | 30x20x10 |



| Pin No. | Description |
|---------|--------------|
| 1 | Input/Output |
| 2 | Output/Input |
| 3,4 | Ground |

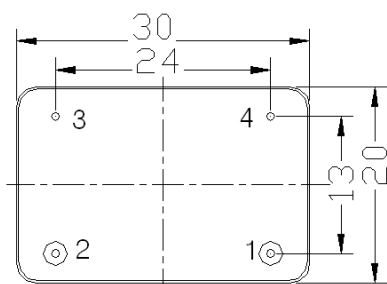

Bottom View

Unit:mm